

ZONING DISPLAY MAP

Note that under the County's current zoning map, the two smallest parcels created under the boundary line adjustment would be sub-standard parcels far below the zoning minimums applicable to the area.

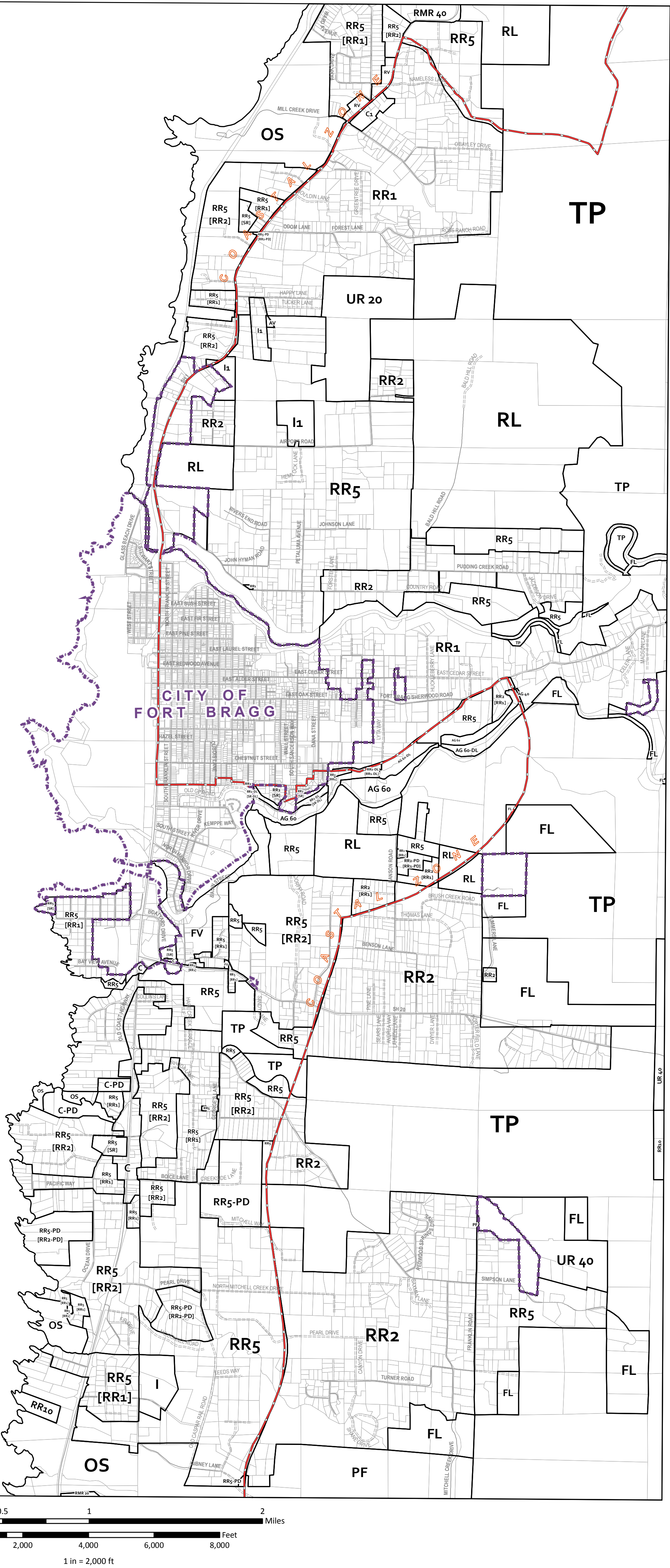

ABBREVIATION KEY

AG	Agricultural Lands	I1-CR	Inland Limited Industrial (Contract Rezone)	UR-CR	Upland Residential (Contract Rezone)	MC	Mendocino Commercial
AG-CR	Agricultural (Contract Rezone)	I2	Inland General Industrial	UR-PD	Upland Residential (Planned Development)	MFL	Mendocino Forestland
AV	Airport District	OS	Open Space	R1	Single Family Residential	MMU	Mendocino Mixed-Use
C	Coastal Commercial	OS-CR	Open Space (Contract Rezone)	R2	Two Family Residential	MOS	Mendocino Open Space
C-PD	Coastal Commercial (Planned Development)	PI	Pinoleville Industrial	R3	Multi Family Residential	MPF	Mendocino Public Facility
C1	Inland Limited Commercial	PF	Public Facility	RMR	Remote Residential	MRM	Mendocino Multi-Family Residential
C1-CR	Inland Limited Commercial (Contract Rezone)	PF-PD	Public Facility (Planned Development)	RMR-DL	Remote Residential (Development Limitation)	MRR	Mendocino Rural Residential
C2	Inland General Commercial	RC	Rural Community	RMR-PD	Remote Residential (Planned Development)	MSR	Mendocino Suburban Residential
C2-CR	Inland General Commercial (Contract Rezone)	RC-CR	Rural Community (Contract Rezone)	RR	Rural Residential	MTR	Mendocino Town Residential
C2-IS	Inland General Commercial (Isolated Service)	RL	Rangeland	RR-CR	Rural Residential (Contract Rezone)	GPD	Gualala Planned Development
FL	Forestland	RL-PD	Rangeland (Planned Development)	RR-DL	Rural Residential (Development Limitation)	GVMU	Gualala Village Mixed Use
FV	Fishing Village	SR	Suburban Residential	RR-PD	Rural Residential (Planned Development)	GHMU	Gualala Highway Mixed Use
I	Coastal Industrial	TP	Timberland Production	RR-PD-DL	Rural Residential (Planned Development Limitation)	GI	Gualala Industrial
I1	Inland Limited Industrial	UR	Upland Residential	RV	Rural Village	RR_[RR_]	Variable Density Zone (see note below)

Zoning designations shown in [brackets] (coastal zone only) indicate 'variable density zones'. Per county code Sec. 3.8-10 in order to be developed to the smaller parcel size, areas indicated on the map as having a variable density zoning classification shall be required to be served by a public water system which utilizes surface waters, and which does not impact upon the ground water resource, or by completion of a hydrological study which supports those greater densities.

FORT BRAGG  
USGS QUADRANGLE BASE

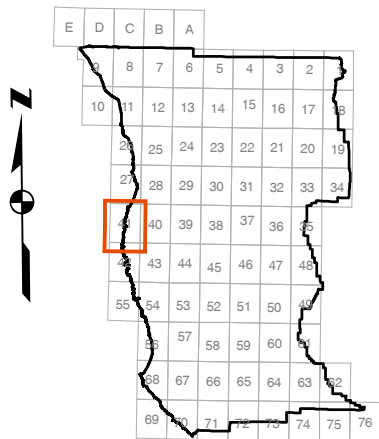

ZONING DISPLAY MAP



PRODUCED 2016  
MENDOCINO COUNTY  
PLANNING & BLDG. SVCS.  
**THIS IS NOT AN ADOPTED MAP**  
FOR DISPLAY PURPOSES ONLY  
Print Date: 11/8/2016